

TOWER AIR COOLER

Important!

Please read this manual carefully before operating your Product and retain this manual for future reference. Follow all instructions and explanations while handling and installing your Product. Keep the operation instructions handy for later use. If the Product is sold or passed on then ensure that the new owner always receives this manual.

A little preventive care on your part can help prolong the life and usage of the Product.

Read our user manual and warranty card carefully before using/operating the Product and retain it for future reference.

WELCOME NOTE

Congratulations!

Welcome to the Kelvinator family!

As the proud owner of a Kelvinator Air Cooler, we urge you to share your valuable feedback and experience (about purchase, demo, Product utility, etc.) on email or our Toll-free number.

Your inputs and feedback will not only encourage us to design better and more user-friendly Products, but will also help us in improving our current Product range. This is our humble way of making life better for our family members who are spread all over the world.

Cheers!

Team Kelvinator

Note



The Tower Air Cooler, here-in-after will be referred to as the "Product" in this user manual and Warranty card.

CONTENTS

SAFETY INSTRUCTIONS

Important Safety Instructions	01
Warning	02
Installing the Product	02

KNOW YOUR PRODUCT

Product Description	04
---------------------	----

USAGE INSTRUCTIONS

Installation Area	05
Unpacking the Air Cooler	05
Preparation before using Air Cooler	06
Control Operation	07

MAINTENANCE

Cleaning and Draining the Water Tank	08
Cleaning of honeycomb	08
Easy steps to remove back panel honeycomb	09
Troubleshooting	10

PRODUCT DETAILS

Product Features Matrix	12
Technical Specifications	12

E-WASTE MANAGEMENT

Environmental Instruction	13
---------------------------	----

SAFETY INSTRUCTIONS

▪ Important Safety Instructions



For your safety, the information in this manual must be followed to minimize the risk of fire or explosion, electric shock or to prevent property damage, personal injury or loss of life.

- Before using the Product check for any damage. If there is any damage, do not use the Product & immediately contact the Retailer/Shopkeeper.
- Do not operate the Product with a damaged cord/plug or If it dropped and damaged in any manner. If the Product requires any safety related attention please call on toll -free number.
- To protect against fire, electric shock or injury, do not place a cord, plug or Product in water or any other liquid.
- Do not let the cord hang over the edge the of table or touch hot surfaces.
- Do not place the Product on or near a hot gas/ electric burner/in a microwave/heated oven.
- Do not install the Product in an area prone to combustible gas leaks, grease or metal dust.
- This Product is not intended to be used by people including children with reduced physical, sensory or mental capabilities or a lack of experience and knowledge unless they have been given supervision or instructions concerning the use of the Product by a person responsible for their safety.
- To protect against electric shock, always unplug from the outlet when not in use and before cleaning. To disconnect, remove the plug from the outlet. Do not yank on the cord as it may damage the cord and eventually cause an electric shock.
- To avoid burns/cuts/risk of personal injury, use extreme caution while handling the Product.
- Do not use for other than intended use. This Product is intended for household use only, not for commercial or industrial use. Use for anything other than intended will void the warranty.
- To avoid an electrical overload, do not operate another high-wattage Product on the same power socket.
- The use of an accessory attachment not approved by the manufacturer may result in fire, electric shock or injury.
- Avoid contact with pets, plants and insects when the Product is in operation.

SAFETY INSTRUCTIONS

▪ **Warning**

The electrical shock

- Before any maintenance, unplug the Product from the mains.
- When connected to the Power, a dedicated Socket to be used.
- The Power cord should not be bent or under pressure of heavy objects.
- Do not use modified or altered length of the power cord.
- Clean dust and the power cord pin before inserting into power socket.
- In case of power cord is damaged or socket holes are loose, do not switch on the Air Cooler.
- Do not touch power cord with wet hand and clothes.
- Do not pull the wire, hold the Power Cord head to plug and unplug from power outlet.
- Do not use any "T" Junction to share power for other Products.
- Do not put the power cord under stress.

Risk to children

- Children shall not play with the Product. Cleaning and user maintenance should not be made by children without supervision.
- Animals and children are not allowed to climb the Product. Check the Product before every operation.
- Young children should be supervised so that they do not play with the Product.
- Do not allow children to put foreign parts into the Cooler from the front panel opening.
- Do not allow children to move the cooler with Tank filled with water.
- Do not allow children to pull the Air cooler with Power Cord.

Risk of explosion

- Do not keep items such as burning candles on the top or sides of the cooler.

Installing the Product

- The opening of air-throw must not be obstructed by any components /parts.
- Air Cooler shall not be installed in the bath room or very wet rooms as well as in the rooms with explosive or caustic gases.
- Remove all packing before using the Product.
- The Plug must be accessible after installation.
- The Floor must be level so that there won't be any issue of uniform wetting of honeycomb.

SAFETY INSTRUCTIONS

- The Air Cooler with a single inlet valve only can be connected to the coldwater supply. (Applicable for specific models only)

Risk of damaging Products

- Do not climb up and sit on top of Air Cooler.
- Do not lean against Air Cooler while running.
- Do not move the Air Cooler with water-filled from one end to another.

Operating the Product

- During the first-time operation of new Air Cooler, it is suggested to run the air cooler for 15 minutes in no-load condition (no water used and pump to be turned off).
- Fill the water in Air Cooler and run the cooler for 2 hours. It will remove any unpleasant smell.
- Flammable and explosive or toxic solvents are forbidden to be used or mixed with water in the tank.
- Ensure to keep the window open for fresh air enter and get cooling inside the room.
- Never refill the water during air cooler is under operation.

KNOW YOUR PRODUCT

▪ Product Description/ Model Number - KCT030DGC

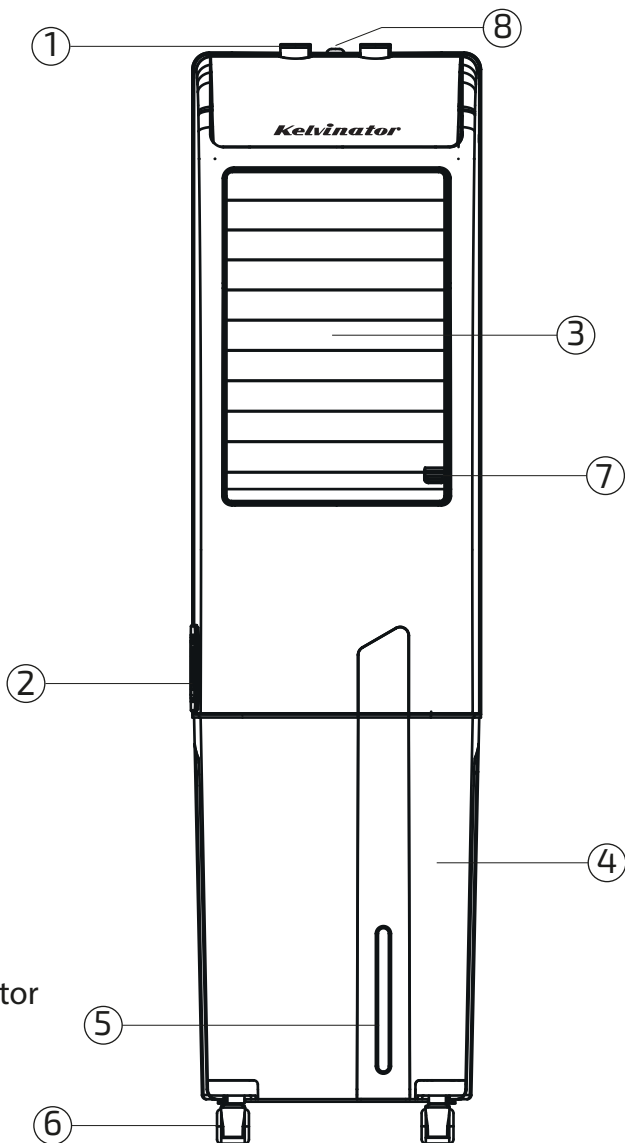

- 1. Control Panel
- 2. Water Inlet
- 3. Horizontal Louver
- 4. Water Tank
- 5. Water Level Indicator
- 6. Castor Wheels
- 7. Louver Lever
- 8. Ice Chamber



The picture is for reference only; please refer to the real Product as standard. Attachments & accessories may vary depending upon model you have purchased.

USAGE INSTRUCTIONS

■ Installation Area



- Stability is important to prevent the Product from Wandering/ Vibration.
- Make sure that the Product should not stand on the power cord.

Before installing the Product, the location characterized as follow shall be selected:

1. Rigid, dry & levelled surface.
2. Avoid direct sun light.
3. Sufficient ventilation.
4. Keep far away from heat resources such as coal or gas.



Room with open windows & door
(RECOMMENDED)



Room with close windows & door
(NOT RECOMMENDED)

■ Unpacking the Air Cooler

- Remove the cardboard box and Styrofoam packing.
- Lift the Air Cooler and remove the base packing.
- Remove the Tie warp securing the power cord.
- Remove castor wheels and install them on the cooler. (Ensure wheels with locks should be fixed on the front side of the cooler (*for specific models).



- Packaging material (e.g. Films, Styrofoam, Polybag) can be dangerous for children.
- There is a risk of suffocation! keep all packaging well away from children.

USAGE INSTRUCTIONS

■ Preparation before using Air Cooler



- Before using for air cooling please make sure it's installed properly.
- Before using it at first time, the Air Cooler shall be operated in dry mode for 15 mins and then with water filled for 2 hrs, to clear odour.
- Water level indicator does not signify minimum or maximum level of water inside tank, it is only for judgment.

■ Cooling



Following steps to be followed during air Cooler installation.

1. Always ensure that your Cooler is plugged into rated voltage, frequency & earthing outlet only.
2. First make dry run to check all the function of the Cooler.
3. Fill water into the tank with Filler/Pipe, fill till the level of Indicator shown. (Caution: Do not overfill the tank)
 - Fill the water in the Ice box/chamber area.



(Only selected models)

(Caution: Do not overfill the tank)

4. Ice cube can be poured into the Ice box/ chamber provided for more effective cooling.
5. Switch "ON" the power supply.
6. Switch "ON" the pump 5 minutes before switching ON the fan for Proper honey pad wetting.
7. Run the Cooler for 2 hours so that during first run all the unpleasant odour gets cleared.



- Do not overfill.
- Do not start fan first, let honeycomb pad wet first.
- Few drops of water will spill at the start from the air Cooler grills.

USAGE INSTRUCTIONS

■ Understanding the Control Operation

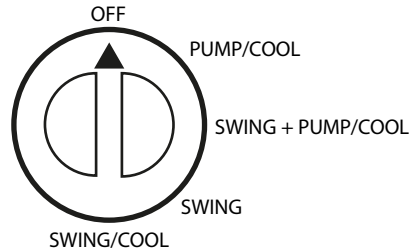
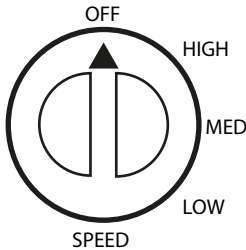

1. **POWER:** Cooler will be turned ON if you rotate the "POWER" knob clockwise to select ON and Cooler will be turned OFF if you rotate the "POWER" knob anti-clockwise to select OFF (for 3 Switch Control.)
2. **POWER:** Cooler will be turned ON if you rotate the "POWER/ SPEED" knob clockwise to select ON (HIGH) and Cooler will be turned OFF if you rotate the "POWER/ SPEED" knob anti-clockwise to select OFF. (for 2 Switch Control.)
3. **SPEED CONTROL:** Rotate the "SPEED" Knob clockwise to get desired level of speed (High, Medium, Low) for air delivery and rotate "Speed Control" knob anti-clockwise to select "OFF" only fan motor will be powered off.
4. **COOL/PUMP:** Rotate the "SWING/COOL/PUMP " or "FUNCTION" knob clockwise to select "COOL/PUMP" function. It will activate the water pump to circulate water in cooling pad for cool air.
5. **SWING + COOL:** Rotate the "SWING/COOL" or "FUNCTION" Knob clockwise to select the "SWING+COOL" function to get cool air with auto vertical deflection.
6. **SWING:** Rotate the "SWING/COOL" or "FUNCTION" knob clockwise to Select "SWING" function for auto air deflection in vertical direction. The swing function can be stopped at your desired angle.
7. **FUNCTION:** All the functions will be turned off if you rotate the "SWING/COOL" or "FUNCTION" knob anti-clockwise to select OFF.

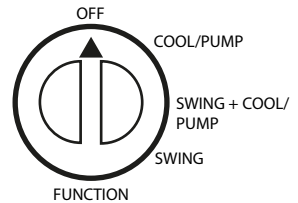
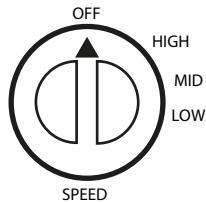
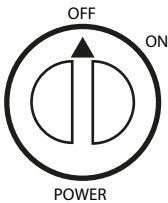

1. For Dry air, keep cool function "OFF".
2. The picture above is only for reference. The actual configuration will depend on physical Product.

MAINTENANCE

■ Cleaning and draining water tank

- Before cleaning the Cooler, switch the Product OFF and remove the power cord plug from socket.
- Move the Product to a location where the water can be drained. Remove the drain plug located at the bottom of the Product, to empty the tank.
- Refill the water tank with clean water up to the maximum level and drain it completely.
- Use a damp cloth to remove the dirt and dust from the surface of the Product, never use corrosive elements or chemical to clean this Product.
- When the Product is not in use, store the Product in a dry place away from direct sunlight.

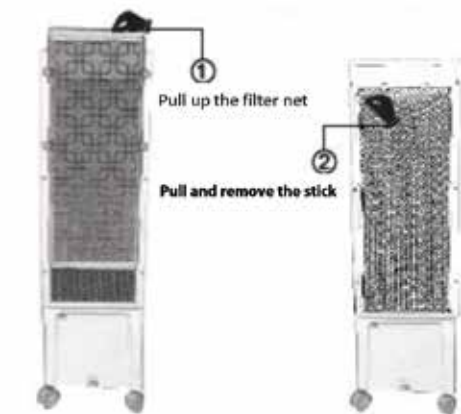

④ Wash thoroughly Honeycomb pad with clean water
Please do not use any kind of hazardous chemical

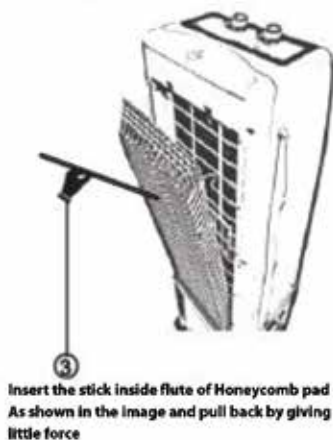

■ Cleaning of Honeycomb

- Before cleaning the honeycomb pad, switch the Product OFF and remove the power cord plug from the socket.
- Pull the filter net out and remove the Stick/ Wire holding the honeycomb.
- Remove the honeycomb from the cooler Product and clean the honeycomb by pouring clean water until accumulated dust gets removed.
- Fix the disassembled honeycomb pad back to the panel and refit it.

MAINTENANCE

▪ Easy steps to honeycomb cleaning

Step 1



Pull up the filter net

Step 2

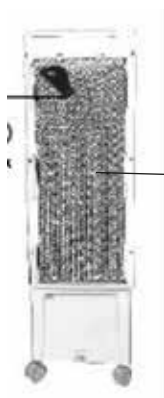

Pull and remove the wire

Step 3



Insert the stick inside flute of Honeycomb pad as shown in the Image and pull back by pulling gently to remove honeycomb pad from Cooler.



After the check, activate the Air Cooler. If the problem occurs, please contact the service centre.

MAINTENANCE

▪ Troubleshooting

Sr. No.	Type of Problem	Possible Cause	Quick Solution
1	No discharge of air.	Power Cord is not plugged in.	Make sure power cord is plugged in and the supply switch is ON.
		Power supply cut.	Check that Product main supply plug is connected to main socket and supply is ON.
			Check if the House Fuse is Intact in the supply line.
2	Not Cooling / Product is making Noise.	The pump is not turned ON.	Turn ON Cool Function from Control Panel.
		Low or no water in the tank when cool is selected.	Refill water in the tank.
		Damaged pump or Calcium deposits on Blower.	Contact service person.
3	Odour emission	New Product	When the Product is used for the first time the honeycomb cooling media will have odour which will dissipate within a week of initial use.
		Old Product	There may be an Algae issue, Replace the honeycomb cooling media, Contact the service person.

MAINTENANCE

▪ Troubleshooting

Sr. No.	Type of Problem	Possible Cause	Quick Solution
4	Cooler not operating initially.	Power Cord is not plugged in.	Make sure power cord is plugged in and the supply switch is ON.
		Power outlet or faulty power supply.	Check the power outlets. Check the power supply with the technician.
		Incorrect Voltage	Check that the power supply is the same as specified on the rating label
5	Noise.	Motor assembly if the screw is loose.	Retighten the screws of the motor.
		Pump is running in dry condition.	Refill water in the tank.



Given technical details are for information only, do not try to service your Air Cooler by yourself until & unless you are instructed or trained for doing so.

PRODUCT DETAILS

▪ Product Features Matrix

Parameters	Models
	KCT030DGC
Inverter Compatibility*	√
Dry Run Protection	√
4-Way Deflection	√
Water Level Indicator	√
Long Air Throw**	√
Remote control function	X
Castor Wheel	√
Mosquito dust filter net	√
Ice Chamber	√
speed control feature	√

▪ Technical Specifications

Parameters	Models
	KCT030DGC
Rated Voltage and Frequency (VAC/ Hz)	230 V, 50 Hz AC, 1-Phase
Power Consumption (Watts)	155



*Performance of cooler may vary depending on the Inverter load capacity.

**Tested under internal lab testing method, performance of cooler will vary depends on environment condition.

E-WASTE MANAGEMENT

■ Environmental Instruction

(Correct disposal of this Product as per E-Waste Management and Handling Rules.)



This marking on the Product, accessories or literature Indicates that the Product and its electronics accessories (e.g. charger, battery, cables, etc.) should not be disposed off with other household waste at the end of their working life.

Electronic equipment's contain many hazardous metallic contaminants such as lead, cadmium and beryllium and brominated flame - retardants Improper handling and/or improper recycling of the Electronic Waste results in these hazardous metals/substances getting released into our eco and biological system, thereby leading to various health hazards. So, to prevent possible harm to the environment or the human health from uncontrolled waste disposal, please separate these items from other type of waste and recycle them responsibly to promote the sustainable reuse of material resources.

Do's

- Always drop your used electronic Products, batteries and accessories after end of their life in nearest authorized collection point/center or hand over to authorized recycler for disposal.
- Drop the discarded Electronics Equipment's only in the bins meant for the Electronic Waste.

Don'ts

- The Product and its accessories are not meant for mixing into household waste stream or regular garbage bins.
- Do not dispose damaged or leaking Lithium ion (Li-ion) battery with normal household waste.

Information for improper disposal & handling

- Any disposal through unauthorized agencies/person will attract action under Environmental (Protection) Act, 1986.
- If batteries are not properly disposed off, it can cause harm to human health or the environment.

For more information on safe disposal and recycling, please call on toll free number 1800 309 0950 or visit our website <https://www.kelvinator.in/page/e-waste>

Note: This Product is RoHS compliant ✓_{RoHS}

PWM EPR Regd. No. BO-20-000-10-AABCR1718E-22

Kelvinator[®]

Experts at your service
for your Product to perform at its best
For Feedback/Complaints Please write to
care.kelvinator@resq.in
You may also reach us on our
Toll-Free No.: 1800-889-1045



For E-Waste related information, please dial our
Toll-Free No.: 1800-309-0950

Kelvinator is a registered trademark of Electrolux Home Products, Inc. and is used by
Reliance Retail Limited under the license from Electrolux Home Products, Inc.